

- SURFACE OF JOINT MUST BE SMOOTH AND FREE FROM DIRT AND LAITANCE BEFORE AFIXING WATERSTOP.
- WATERSTOP MUST BE GLUED TO THE SURFACE WITH RECOMMDED ADHESIVE.
- IN CASE OF SHOTCRETE APPLICATION, WATERSTOP MUST ALSO BE SECURED AT POSITION WITH CONCRETE NAILS @ 12" MIN SPACING.
- INSTALLATION MUST BE IN ACCORDANCE WITH MANUFACTURERS RECOMMENDATIONS

<p>DETAIL: ABOVE GRADE PENETRATIONS (FLOOR - DRAIN - SLAB)</p>	
<p>LOCATION: ABOVE GRADE</p>	
<p>POUR TYPE: CAST-IN-PLACE</p>	<p>DETAIL #: AGP0001</p>

Specialty Products Group details illustrate generic construction guidelines. They are intended for use by design/construction professionals, to assist in developing project specific details. These should be modified when necessary to accommodate individual project conditions. The user maintains all responsibility for verifying the applicability and suitability of the technical service or information provided. Always refer to project specifications, local building codes and manufacturer's installation procedures.

USE 3/8" X 3/4" HYDROPHILIC WATERSTOP FOR ALL PIPE PENETRATIONS LESS THAN 1-1/2" DIA.

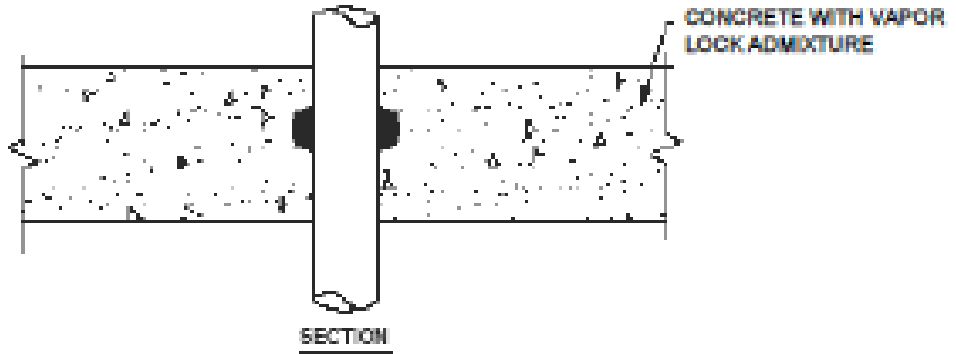

USE MIN. 1" X 3/4" HYDROPHILIC WATERSTOP FOR ALL PIPE PENETRATIONS GREATER IN 1-1/2" DIA.

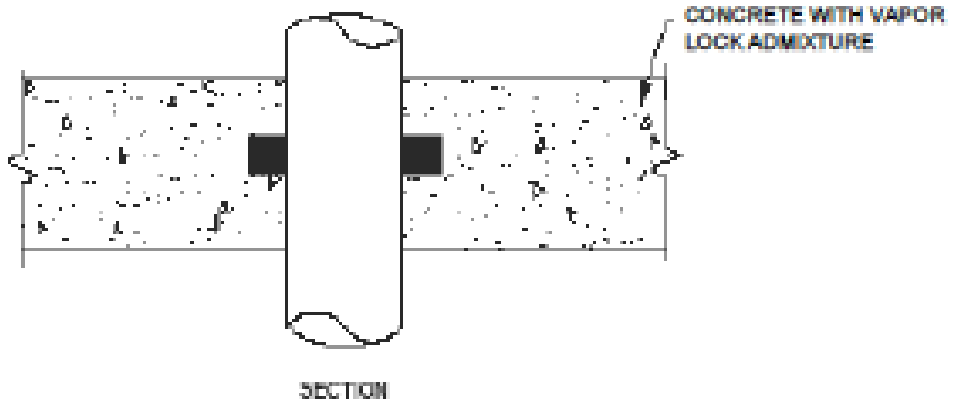

USE MIN. 3/8" X 3/4" HYDROPHILIC WATERSTOP FOR ALL CONGESTED PIPE PENETRATIONS.

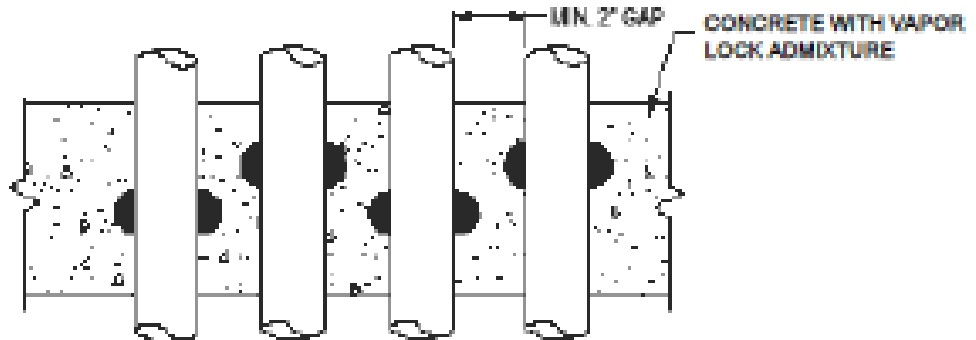

- SURFACE OF JOINT MUST BE SMOOTH AND FREE FROM DIRT AND LAITANCE BEFORE AFFIXING WATERSTOP.
- WATERSTOP MUST BE GLUED TO THE SURFACE WITH RECOMMDED ADHESIVE.
- INSTALLATION MUST BE IN ACCORDANCE WITH MANUFACTURERS RECOMMENDATIONS

DETAIL: ABOVE GRADE PENETRATIONS	
LOCATION: ABOVE GRADE	
POUR TYPE: CAST-IN-PLACE	

Specialty Products Group details illustrate generic construction guidelines. They are intended for use by design/construction professionals, to assist in developing project specific details. These should be modified when necessary to accommodate individual project conditions. The user maintains all responsibility for verifying the applicability and suitability of the technical service or information provided. Always refer to project specifications, local building codes and manufacturer's installation procedures.

DETAIL: COLUMN/ SLAB/FOOTING
JOINT



LOCATION: BELOW/AT GRADE

POUR TYPE: CAST-IN-PLACE

DETAIL #: CSFJ00031

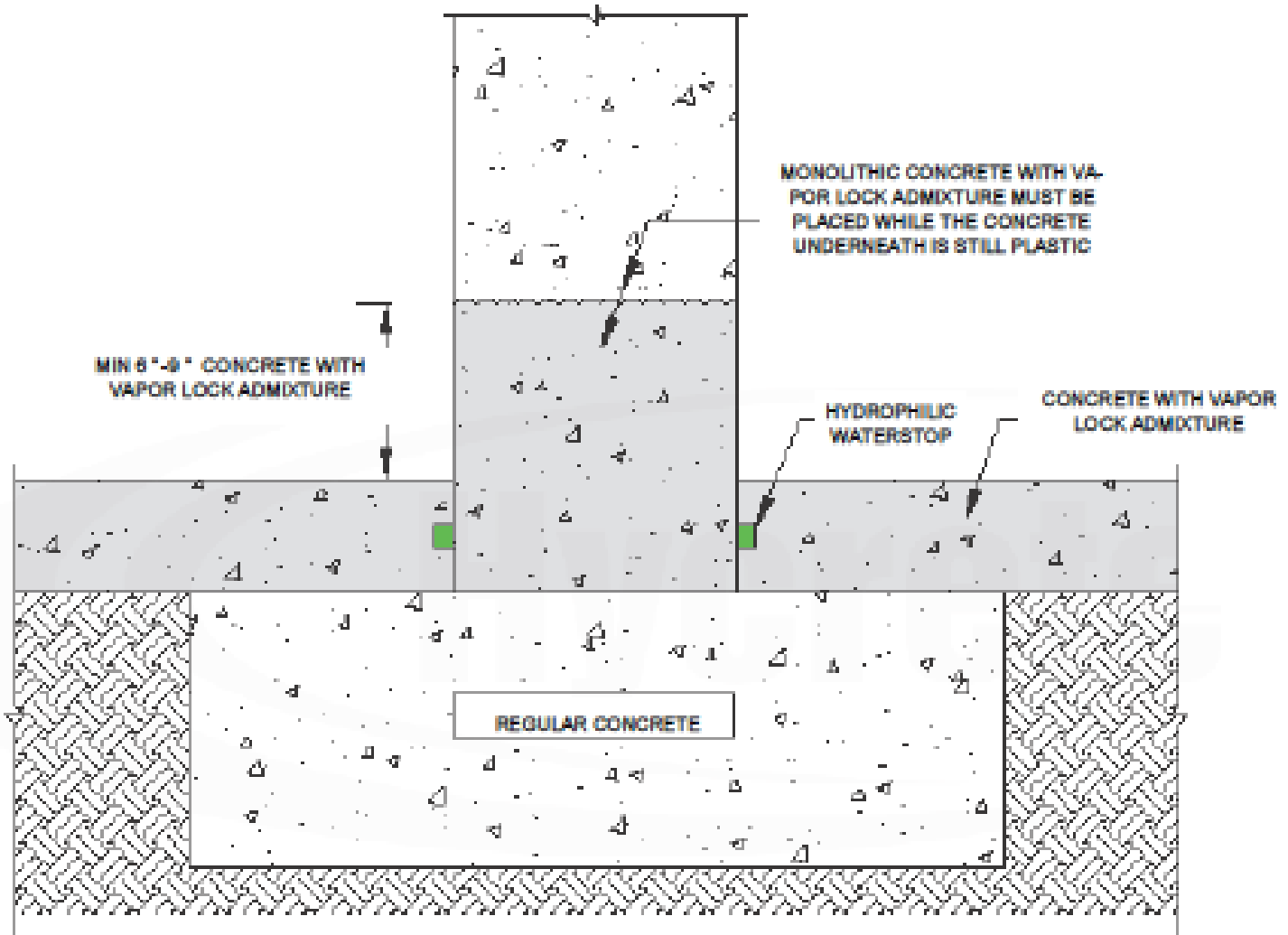

- SURFACE OF JOINT MUST BE SMOOTH AND FREE FROM DIRT AND LAITANCE BEFORE ADDING WATERSTOP.
- WATERSTOP MUST BE GLUED TO THE SURFACE WITH RECOMMDED ADHESIVE.
- IN CASE OF SHOTCRETE APPLICATION, WATERSTOP MUST ALSO BE SECURED AT POSITION WITH CONCRETE NAILS @ 12" MIN SPACING.

Specialty Products Group details illustrate generic construction guidelines. They are intended for use by design/construction professionals, to assist in developing project specific details. These should be modified when necessary to accommodate individual project conditions. The user maintains all responsibility for verifying the applicability and suitability of the technical service or information provided. Always refer to project specifications, local building codes and manufacturer's installation procedures.

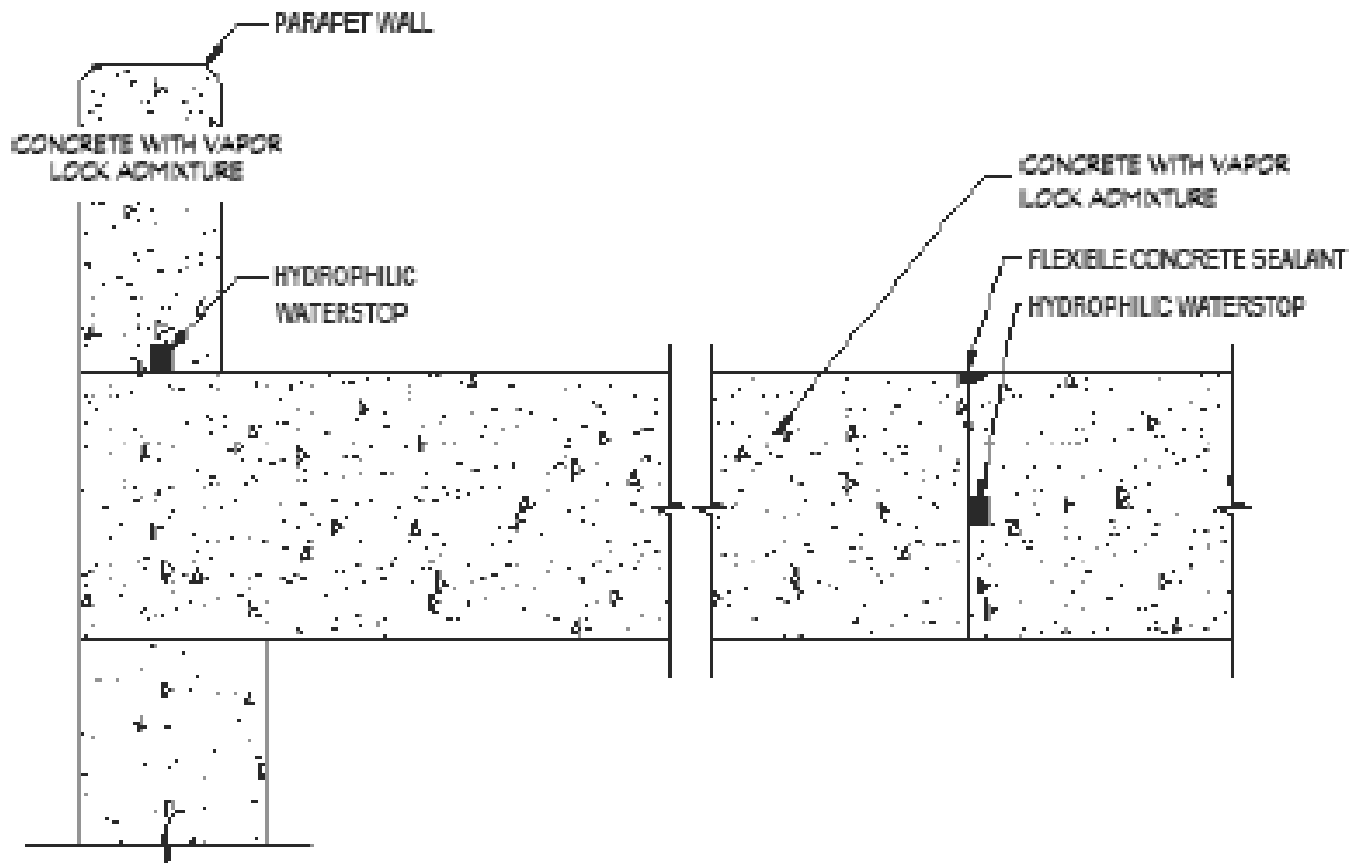

- SURFACE OF JOINT MUST BE SMOOTH AND FREE FROM DIRT AND LAITANCE BEFORE AFIXING WATERSTOP.
- WATERSTOP MUST BE GLUED TO THE SURFACE WITH RECOMMDED ADHESIVE.
- INSTALLATION MUST BE IN ACCORDANCE WITH MANUFACTURERS RECOMMENDATIONS

DETAIL: PODIUM DECK - PARAPET WALL JOINT	
LOCATION: ABOVE GRADE	
POUR TYPE: CAST-IN-PLACE	
	DETAIL #: PWJ0011

Specialty Products Group details illustrate generic construction guidelines. They are intended for use by design/construction professionals, to assist in developing project specific details. These should be modified when necessary to accommodate individual project conditions. The user maintains all responsibility for verifying the applicability and suitability of the technical service or information provided. Always refer to project specifications, local building codes and manufacturer's installation procedures.

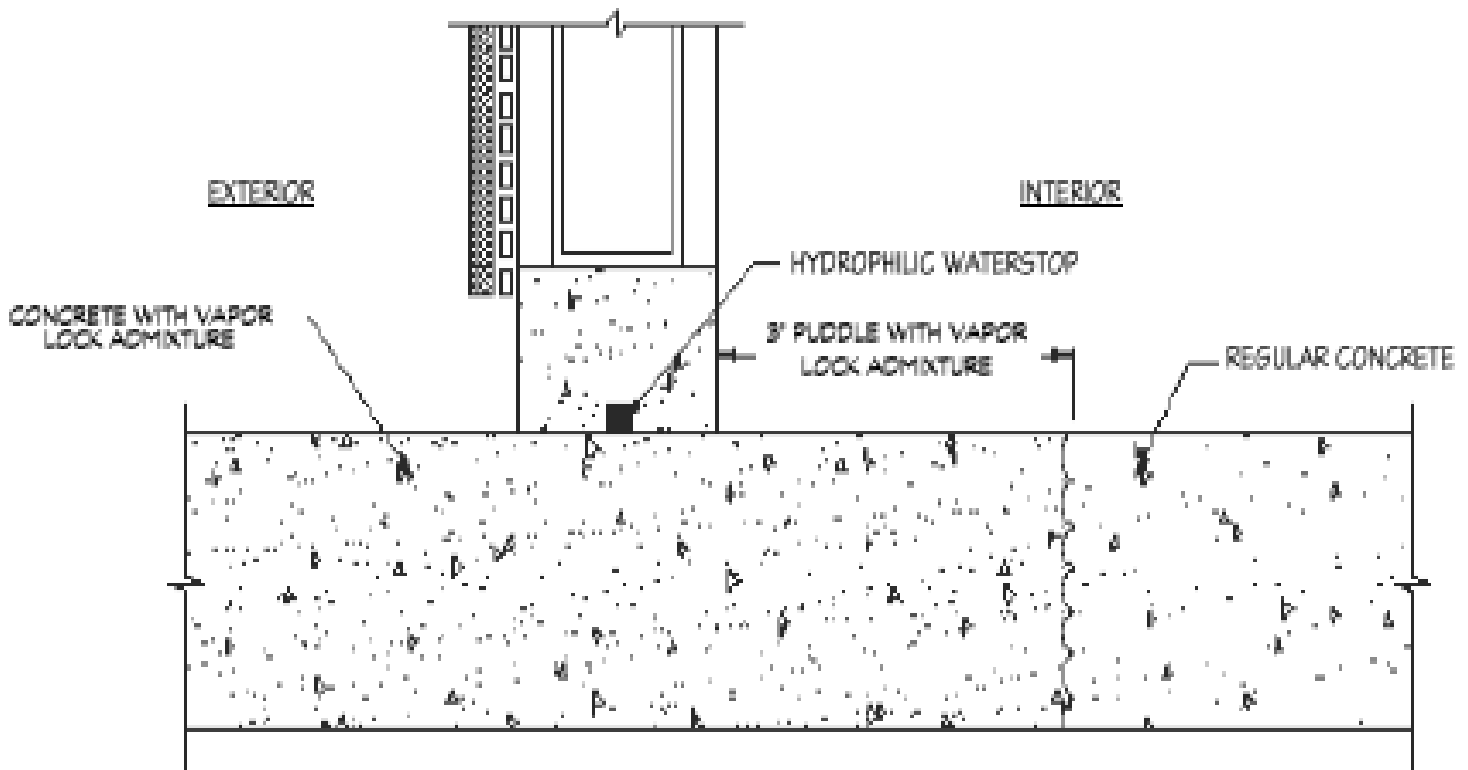

- SURFACE OF JOINT MUST BE SMOOTH AND FREE FROM DIRT AND LAITANCE BEFORE AFIXING WATERSTOP.
- WATERSTOP MUST BE GLUED TO THE SURFACE WITH RECOMMDED ADHESIVE.
- INSTALLATION MUST BE IN ACCORDANCE WITH MANUFACTURERS RECOMMENDATIONS

DETAIL: PODIUM DECK - EXTERNAL WALL JOINT	
LOCATION: ABOVE GRADE	
POUR TYPE: CAST-IN-PLACE	

Specialty Products Group details illustrate generic construction guidelines. They are intended for use by design/construction professionals, to assist in developing project specific details. These should be modified when necessary to accommodate individual project conditions. The user maintains all responsibility for verifying the applicability and suitability of the technical service or information provided. Always refer to project specifications, local building codes and manufacturer's installation procedures.

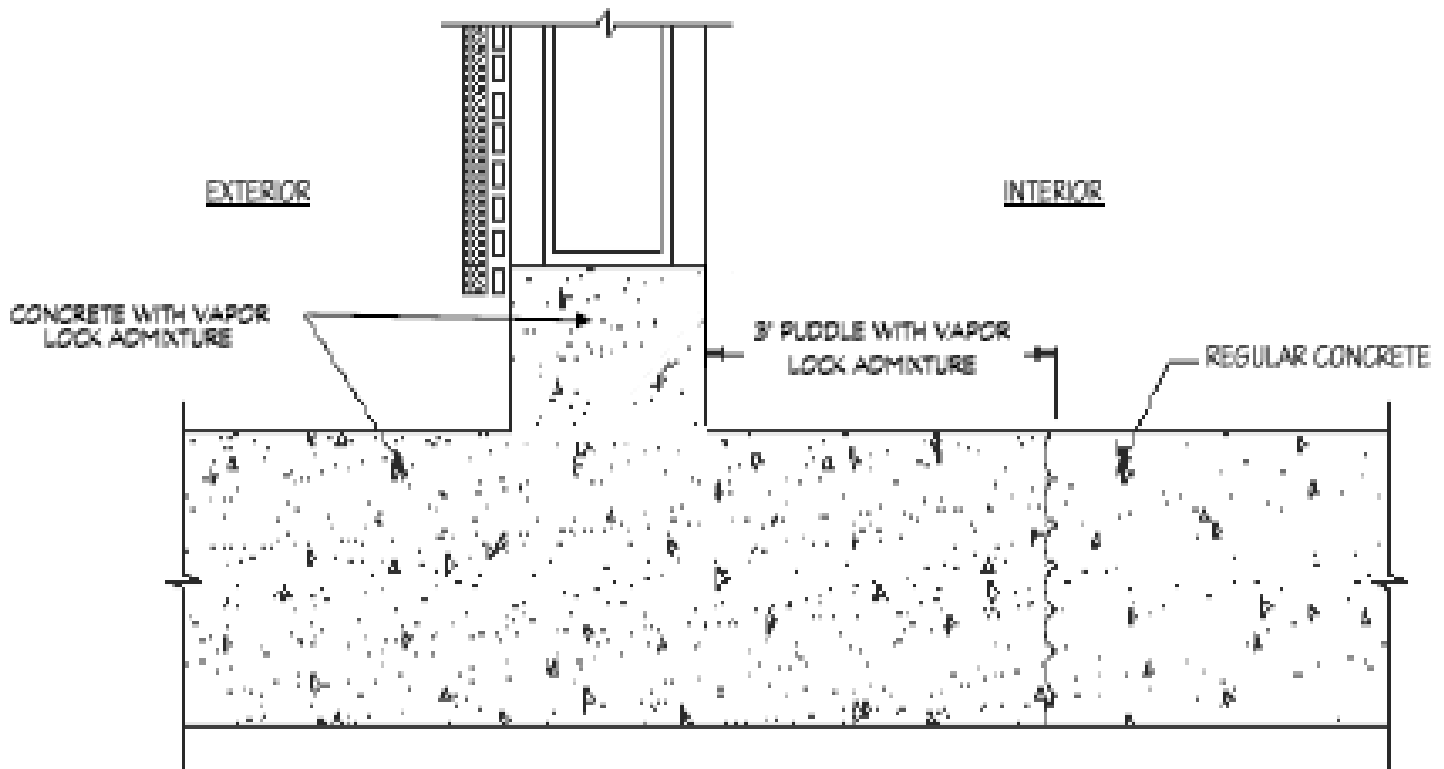

- SURFACE OF JOINT MUST BE SMOOTH AND FREE FROM DIRT AND LAITANCE BEFORE AFIXING WATERSTOP.
- WATERSTOP MUST BE GLUED TO THE SURFACE WITH RECOMMDED ADHESIVE.
- INSTALLATION MUST BE IN ACCORDANCE WITH MANUFACTURERS RECOMMENDATIONS

DETAIL: PODIUM DECK - EXTERNAL WALL JOINT (MONOLITHIC)	
LOCATION: ABOVE GRADE	
POUR TYPE: CAST-IN-PLACE	
	DETAIL #: EWJ0014

Specialty Products Group details illustrate generic construction guidelines. They are intended for use by design/construction professionals, to assist in developing project specific details. These should be modified when necessary to accommodate individual project conditions. The user maintains all responsibility for verifying the applicability and suitability of the technical service or information provided. Always refer to project specifications, local building codes and manufacturer's installation procedures.

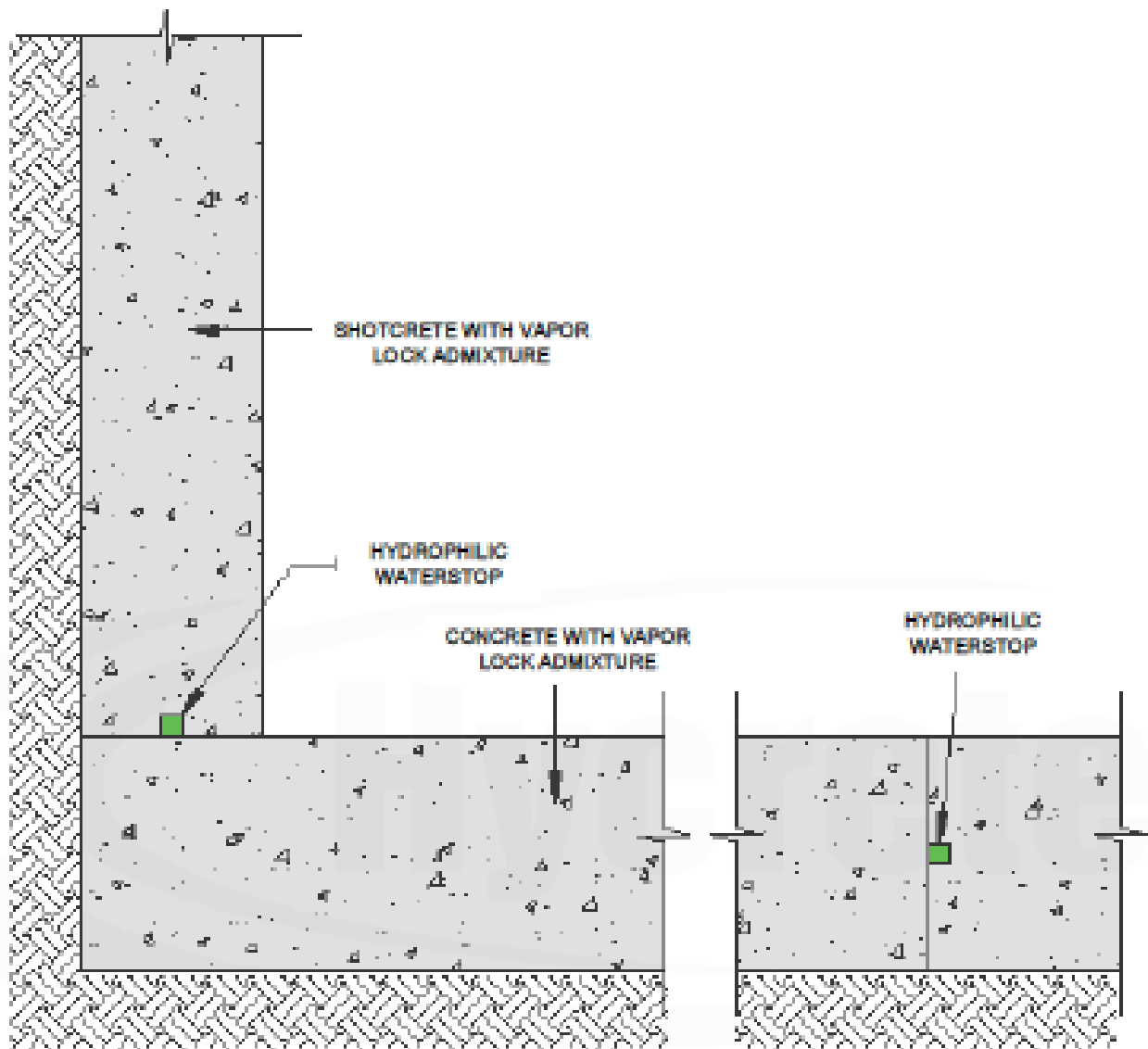

- SURFACE OF JOINT MUST BE SMOOTH AND FREE FROM DIRT AND LAITANCE BEFORE AFFIXING WATERSTOP.
- WATERSTOP MUST BE GLUED TO THE SURFACE WITH RECOMMENDED ADHESIVE.
- IN CASE OF SHOTCRETE APPLICATION, WATERSTOP MUST ALSO BE SECURED AT POSITION WITH CONCRETE NAILS @ 12" MIN SPACING.

DETAIL: WALL/SLAB JOINT	
LOCATION: BELOW GRADE	
POUR TYPE: SHOTCRETE	DETAIL #: WSJ00011

Specialty Products Group details illustrate generic construction guidelines. They are intended for use by design/construction professionals, to assist in developing project specific details. These should be modified when necessary to accommodate individual project conditions. The user maintains all responsibility for verifying the applicability and suitability of the technical service or information provided. Always refer to project specifications, local building codes and manufacturer's installation procedures.

DETAIL: WALL-TIE BACK	
LOCATION: BELOW GRADE	
POUR TYPE: CIP/SHOTCRETE	DETAIL #: TBJ00091

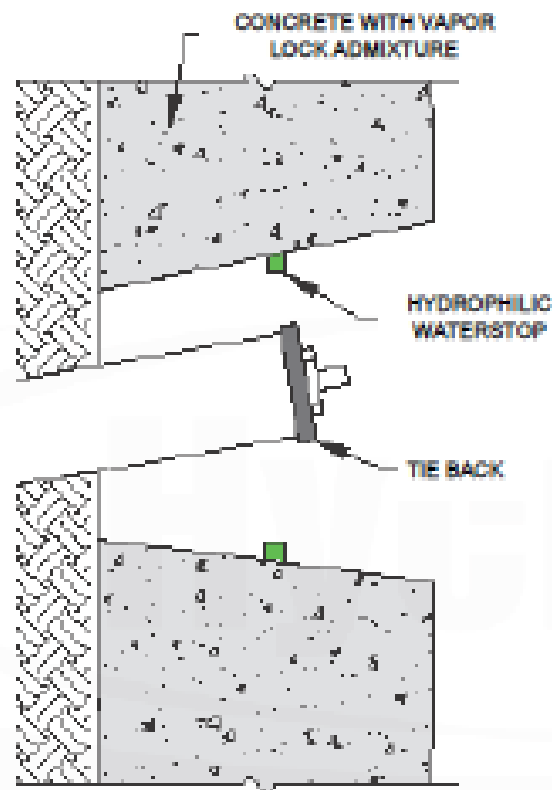

- SURFACE OF JOINT MUST BE SMOOTH AND FREE FROM DIRT AND LAITANCE BEFORE AFFIXING WATERSTOP.
- WATERSTOP MUST BE GLUED TO THE SURFACE WITH RECOMMDED ADHESIVE.
- IN CASE OF SHOTCRETE APPLICATION, WATERSTOP MUST ALSO BE SECURED AT POSITION WITH CONCRETE NAILS @ 12" MIN SPACING.

Specialty Products Group details illustrate generic construction guidelines. They are intended for use by design/construction professionals, to assist in developing project specific details. These should be modified when necessary to accommodate individual project conditions. The user maintains all responsibility for verifying the applicability and suitability of the technical service or information provided. Always refer to project specifications, local building codes and manufacturer's installation procedures.

DETAIL: WALL/MAT SLAB JOINT



LOCATION: BELOW GRADE

Specialty Products Group®

POUR TYPE: SHOTCRETE WALL

DETAIL #: WMSJ00021

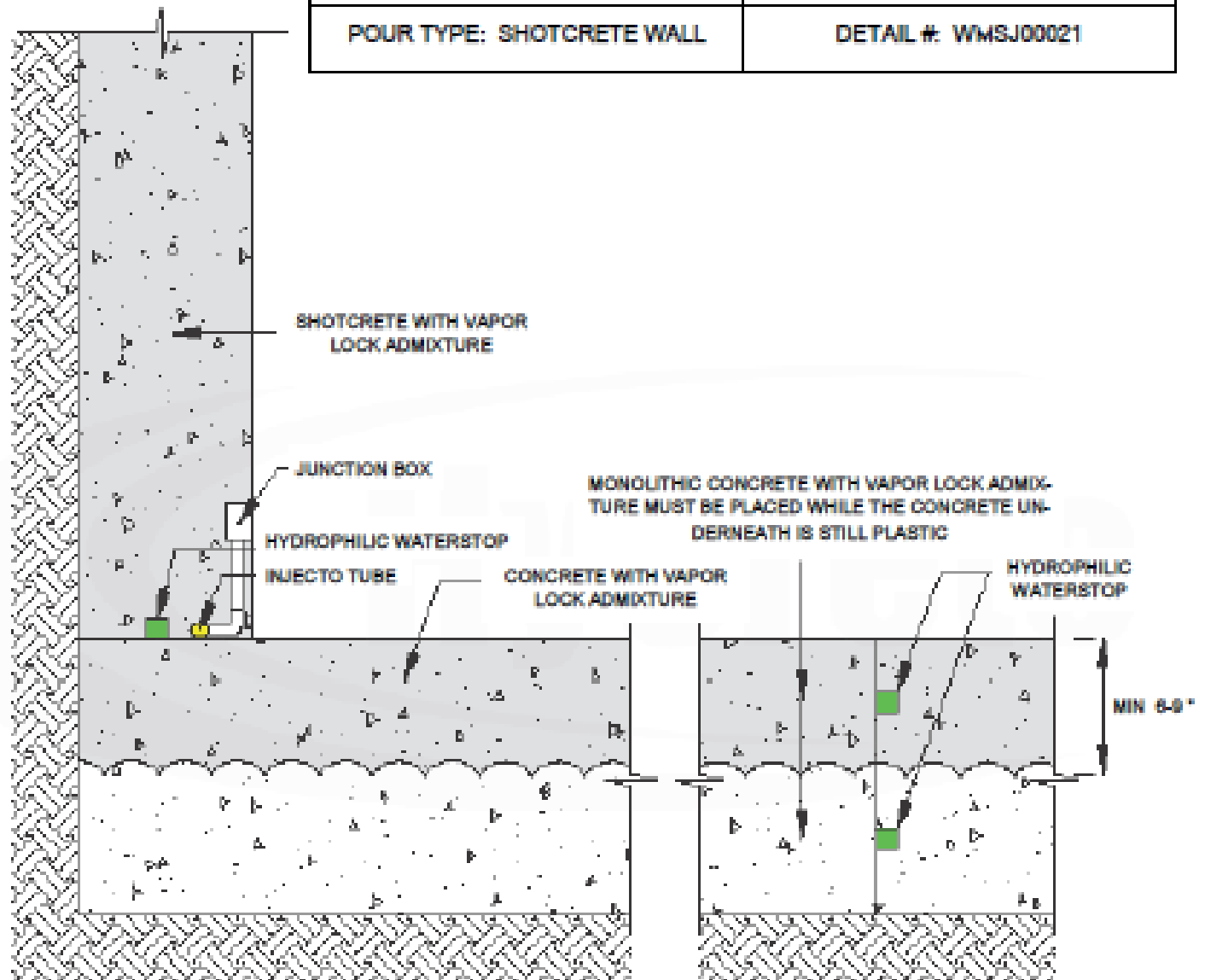

- SURFACE OF JOINT MUST BE SMOOTH AND FREE FROM DIRT AND LAITANCE BEFORE APPLYING WATERSTOP.
- WATERSTOP MUST BE GLUED TO THE SURFACE WITH RECOMMENDED ADHESIVE.
- IN CASE OF SHOTCRETE APPLICATION, WATERSTOP MUST ALSO BE SECURED AT POSITION WITH CONCRETE NAILS @ 12" MIN SPACING.